

## FLOODWOOD ZONE

Pit Name	Legal	Price/cy	Notify Public Works of Permit/ District		Lock, Key Need	Comments/Special Conditions
Arkola 549-11HJ	NW-SE 11-54-19	\$3.50	Y	7	Y	Public Works stockpile. Maintain berm around rock excavation pond. Sandy gravel with some cobble.
Artichoke 518-26M	NW-SW 26-51-18	\$3.50	Y	5	Y	Clean sand, gravel, small cobbles. Limited amount. PW screened stockpiles. Do not take from west side.
Birch 538-34HJ	NE-SE 34-53-18	\$3.50 <b>LAND &amp; PW Use Only</b>	Y	7	Y	Public Works Class 5 stockpile from 2015. Long term multipurpose pit.
Erickson 548-24F	Lot 6 24-54-18	\$3.50	N	6	N	Sand with no rock. Access blocked with boulders. North and west rims bermed. Depleted north pit planted to pine 2015. Must put back rock berm as part of any future permit or lease.
Laine 540-01M	NE-SW 1-54-20	\$3.50	Y	7	Y	Septic sand in NW corner. Long term multiple use pit. Note: Private property boundary on the south side. PW Class 5 stockpile, Toivola TWP, Meadowlands TWP and Lavell TWP.

**Public Works Supervisors: Dist. #5 – Gordy Halverson    Dist. #6 Gerald VanGuilder  
Dist. #7 Chad Walters**

- **Send pit maps to Public Works along with the permit.**

Review Date:03/06/2025  
(JK)



# Floodwood Zone

## Gravel Pits

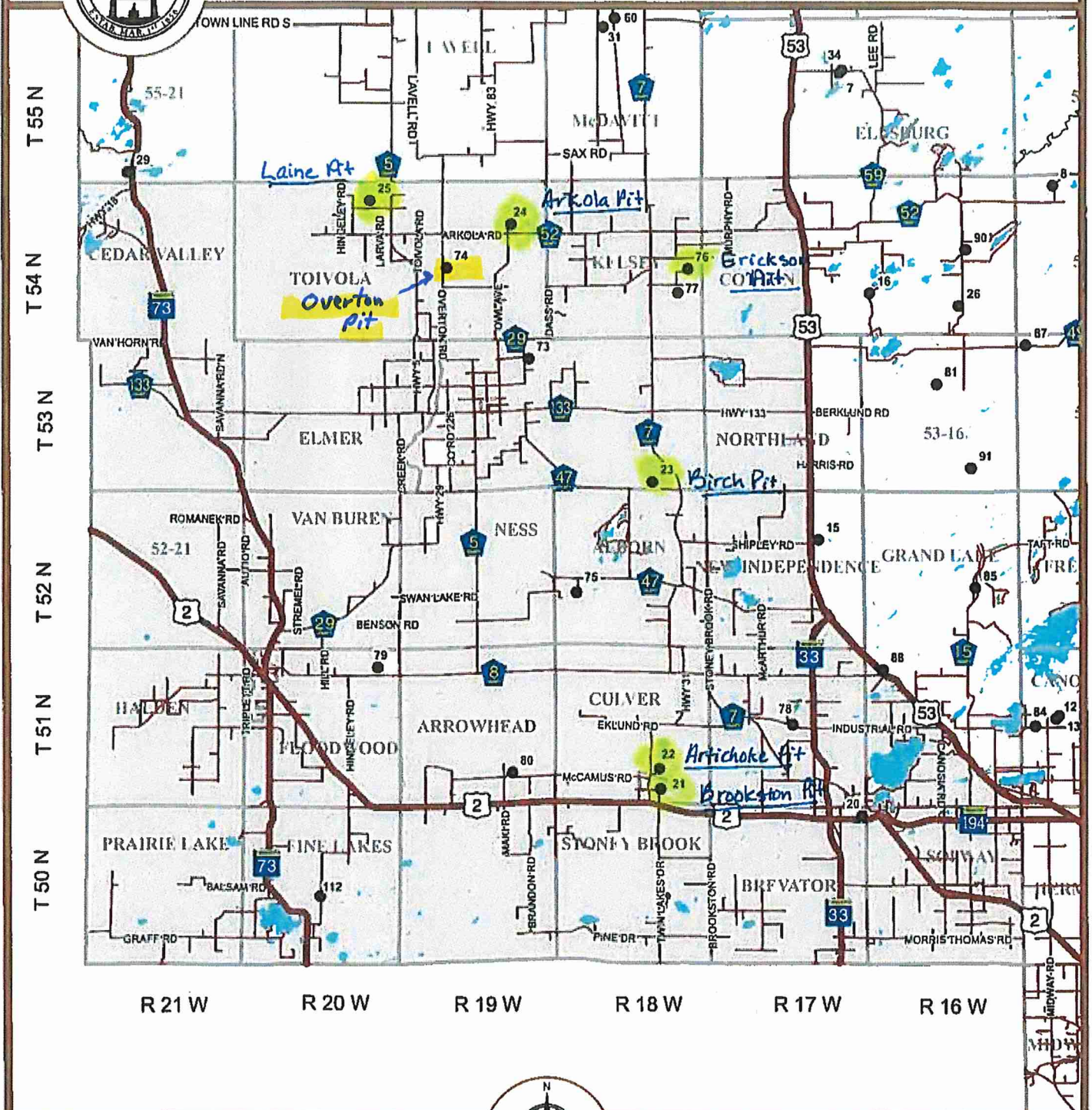

● Land Dept Gravel Pits



Copyright Saint Louis County  
All Rights Reserved

Prepared By: Land Department  
Data Resource Section  
(218) 725-5000  
www.co.st-louis.mn.us

Map Created: 3/4/2008  
Location: M:/GRAVEL

Notes:

### Disclaimer

This is a compilation of records as they appear in the Saint Louis County Offices affecting the area shown. This drawing is to be used only for reference purposes and the County is not responsible for any inaccuracies herein contained.

Tracking #: 10.10



St. Louis County MN