



S A I N T  
**LOUIS**  
**COUNTY**  
M I N N E S O T A

# Land and Minerals Department

## Decorative Products Sealed Bid Auction

Bid opening: August 1, 2024 at 9:30 a.m.

Duluth Government Services Center



Government Services Center  
320 West 2nd Street, Suite 302  
Duluth, MN 55802  
218-726-2606

Pike Lake Area Office  
5713 Old Miller Trunk Highway  
Duluth, MN 55803  
218-625-3700

Virginia Area Office  
7820 Highway 135  
Virginia, MN 55792  
218-742-9898

[stlouiscountymn.gov](http://stlouiscountymn.gov)

## NOTICE OF ST. LOUIS COUNTY DECORATIVE PRODUCTS SEALED BID AUCTION

Notice is hereby given that the St. Louis County Auditor shall sell to the highest bidder the designated timber located on the following described parcels of land forfeited to the State for the nonpayment of taxes, which have been classified and appraised as provided by Minnesota Statutes 282.04, Subd. 1(1982); and that this auction may include other lands which the St. Louis County Land and Minerals Department is authorized to manage, subject, in part, to the following conditions:

1. To be eligible to bid at a St. Louis County Timber auction, a Responsible Operator Application Form must be on file at the St. Louis County Land and Minerals Department, 320 West 2nd Street, Suite 302, Duluth, MN 55802, at least **2 working days prior** to the auction. An application can be obtained at any Land and Minerals Department Office.
2. The timber that will be sold to the highest bidder, but for not less than the total appraised **Tract Value**. A bid value per unit must be indicated for each species listed. This bid value will be applied to each specie. Bid value per unit must meet or exceed the appraised bid value per unit. St. Louis County reserves the right to accept or reject any or all bids.
3. All bid forms must be received in the Duluth Government Services Center **by 4:30 P.M. on July 31st**. All bids must be on the official bid form and sealed in an envelope.
4. A \$300 bid bond, i.e. personal check, payable to the **St. Louis County Auditor** is required and must be included in the envelope with the bid form. One bid bond will cover all tracts and will be returned if the bids are not the successful bidder. For a successful bidder, the bid bond will be applied to the down payment on the first tract awarded.
5. Successful bidders will have **10 days** to submit a check, payable to the St. Louis County Auditor, for the specified down payment of the appraised tract value for each tract awarded. Failure to make any or all of these down payments on time will result in the forfeiture of the bid bond. Successful bidders will be notified by mail.
6. Should the successful bidder not submit the down payment on time, the sale may be awarded to the next highest bidder. In the case of tie bids, the successful bidder will be decided by the toss of a coin by the Auditor.
7. St. Louis County has developed an Environmental Management System to assist it in meeting the Sustainable Forestry Initiative (SFI) standard and is certified to this standard.
8. Some of the tracts may have special requirements. Prospective bidders should get maps, cutting regulations, contract information and special regulations at the applicable Area Office. If there is conflict between the Timber Sale Package and this advertisement, the Timber Sale Package is the controlling document.

# ST. LOUIS COUNTY DECORATIVE PRODUCTS SEALED BID AUCTION

Decorative Products Sealed Bid Auction will be held at:

**St. Louis County Land and Minerals Department  
Government Services Center  
320 West 2nd Street, Suite 302  
Duluth, MN 55802  
9:30 A.M. — August 1st, 2024**

<p>Pike Lake Area Office Nate Anderson, Area Land Manager 5713 Old Miller Trunk Highway Duluth, MN 55811</p> <p>218-625-3700</p>	<p>Virginia Area Office Dave Skurla, Area Land Manager 7820 Highway 135 Virginia, MN 55792</p> <p>218-742-9898</p>
--	--

**St. Louis County Land and Minerals Department does not accept cash payments.  
Payment must be made by Check or Money Order.**

Published as follows is the list of timber to be offered at public auction sale as announced and advertised in the official newspaper within this county.



# St. Louis County August 01, 2024 Timber Auction

Tract #: 1

C24-621924

Sale Administrator: Brandon Pierzina

Virginia Area

Total Appraised: \$17,296.95

Twp. 62N Rge. 19W Sec. 24, 25

C19240065

Down Payment Required: \$4,324.24

Total Acres: 87.1

Expires: 12/31/2025

47° 50.223' N 92° 42.185' W

Blocks: 4

### Comments:

- No extensions will be allowed.
- A minimum of 25% of the downpayment will be retained and will be held until the satisfactory completion of the contract.
- Sale requirements involve cutting tamarack in all blocks and a self-directed thinning of black spruce in blocks 3 & 4 (see harvest provisions for details).
- Black Spruce merchantability is an individual piece where the live crown of the tree measures between 18" and 4' tall and less than 3" in diameter. Black spruce pieces are not to be harvested past 12' up the bole of the tree.
- Tamarack averages 1" DBH with block #1 - 575 trees per acre, block #2 - 742 stems per acre, block #3 - 277 stems per acre, block #4 - 413 stems per acre.

### Access:

Access to this Black Spruce top sale will be from Ralph Rd. About 1.3 miles south of Cook, MN

Block	Operational Periods
1, 2, 3, 4	All Season

SOAV	Product	No Bid	Total Volume	Appraised Value	Total Value
<b>Total For All Blocks</b>					
	Black Spruce soav-tops		115313 Pieces @	\$0.15 =	\$17,296.95
<b>Total Appraised Value:</b>					<b>\$17,296.95</b>

Volume Per Block	Block 1	Block 2	Block 3	Block 4
Black Spruce soav-tops	41499	30374	28268	15172



C19240065

St. Louis County  
C24-621924

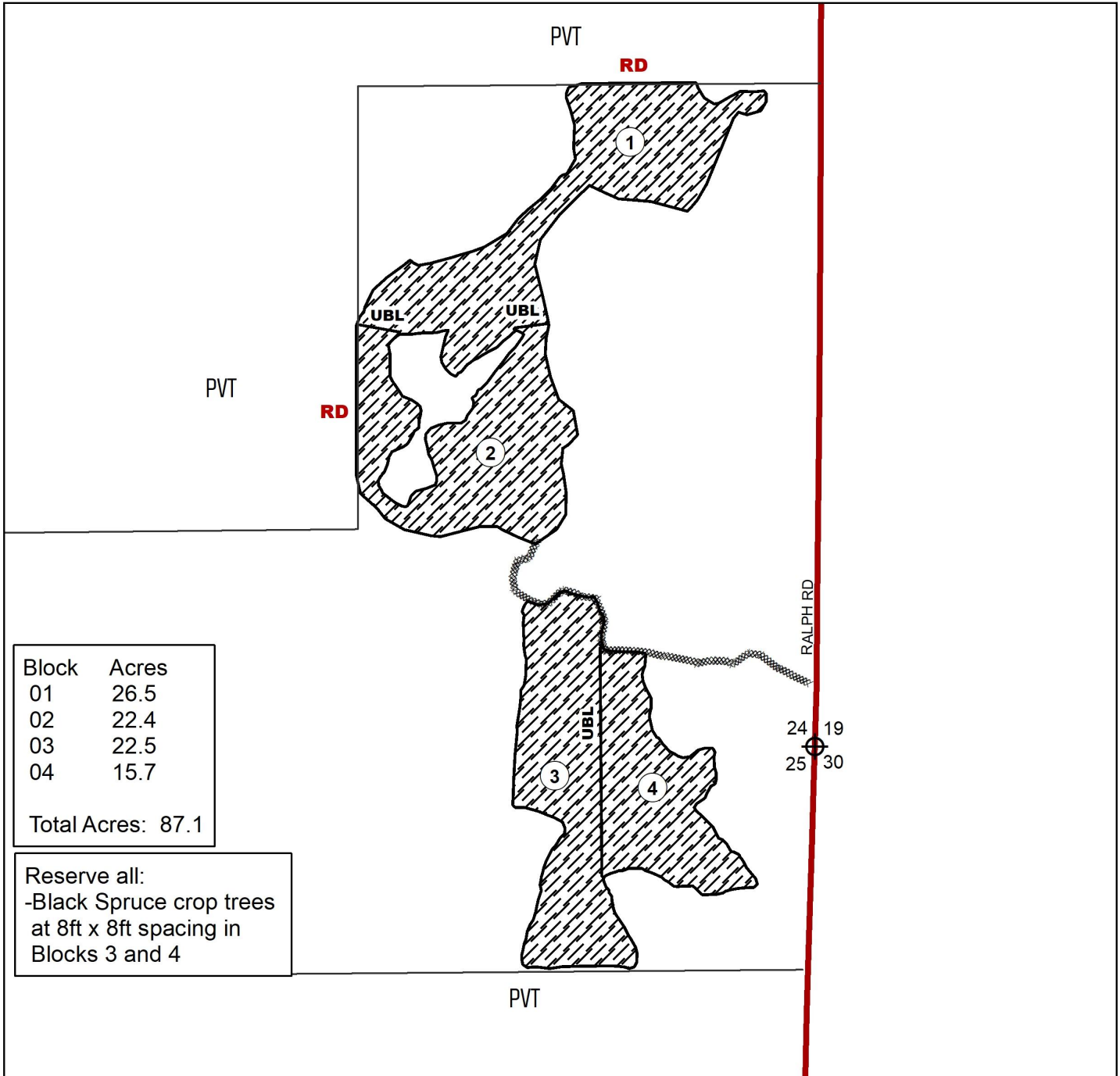

Block	Acres
01	26.5
02	22.4
03	22.5
04	15.7
Total Acres: 87.1	

Reserve all:  
-Black Spruce crop trees  
at 8ft x 8ft spacing in  
Blocks 3 and 4

Prepared By: Brandon Pierzina  
Map Created: 3/25/2024  
TRS: 621924

Disclaimer:  
This is a compilation of records as they appear in the Saint Louis County Offices affecting the area shown. This drawing is to be used only for reference purposes and the County is not responsible for any inaccuracies herein contained.

0 0.1 0.2 Miles

Decorative Forest Products Area (Black Spruce Top Removal) Boundary Marked With Orange Ribbon

Access (Existing)

Section Corner

**RD** Painted Red Line

**PVT** Private

**UBL** Unpainted Block Line

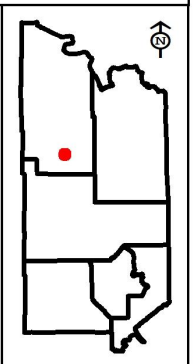



# St. Louis County August 01, 2024 Timber Auction

**Tract #: 2****E24-601510****Sale Administrator: Tom Salzer****Virginia Area****Total Appraised: \$8,950.50****Twp. 60N Rge. 15W Sec. 10****C19240066****Down Payment Required: \$2,237.63****47° 41.614' N 92° 14.143' W****Total Acres: 22.1****Expires: 12/31/2025****Blocks: 1****Comments:**

- No extensions will be allowed.
- The 25% down payment of the appraised value is required with the purchase of the sale and will be held until satisfactory completion of the contract.
- Black Spruce merchantability is an individual piece where the live crown of the tree measures between 18" and 4' tall and less than 3" in diameter. Black spruce pieces are not to be harvested past 12' up the bole of the tree.

**Access:**

-Access is on the Mesabi Trail, vehicle traffic is allowed on the trail to access the harvest area.

Block	Operational Periods
1	All Season

SOAV	Product	No Bid	Total Volume	Appraised Value	Total Value
<b>Total For All Blocks</b>					
	Black Spruce soav-tops		29835 Pieces @	\$0.30 =	\$8,950.50
<b>Total Appraised Value:</b>					<b>\$8,950.50</b>

C19240066

St. Louis County  
E24-601510

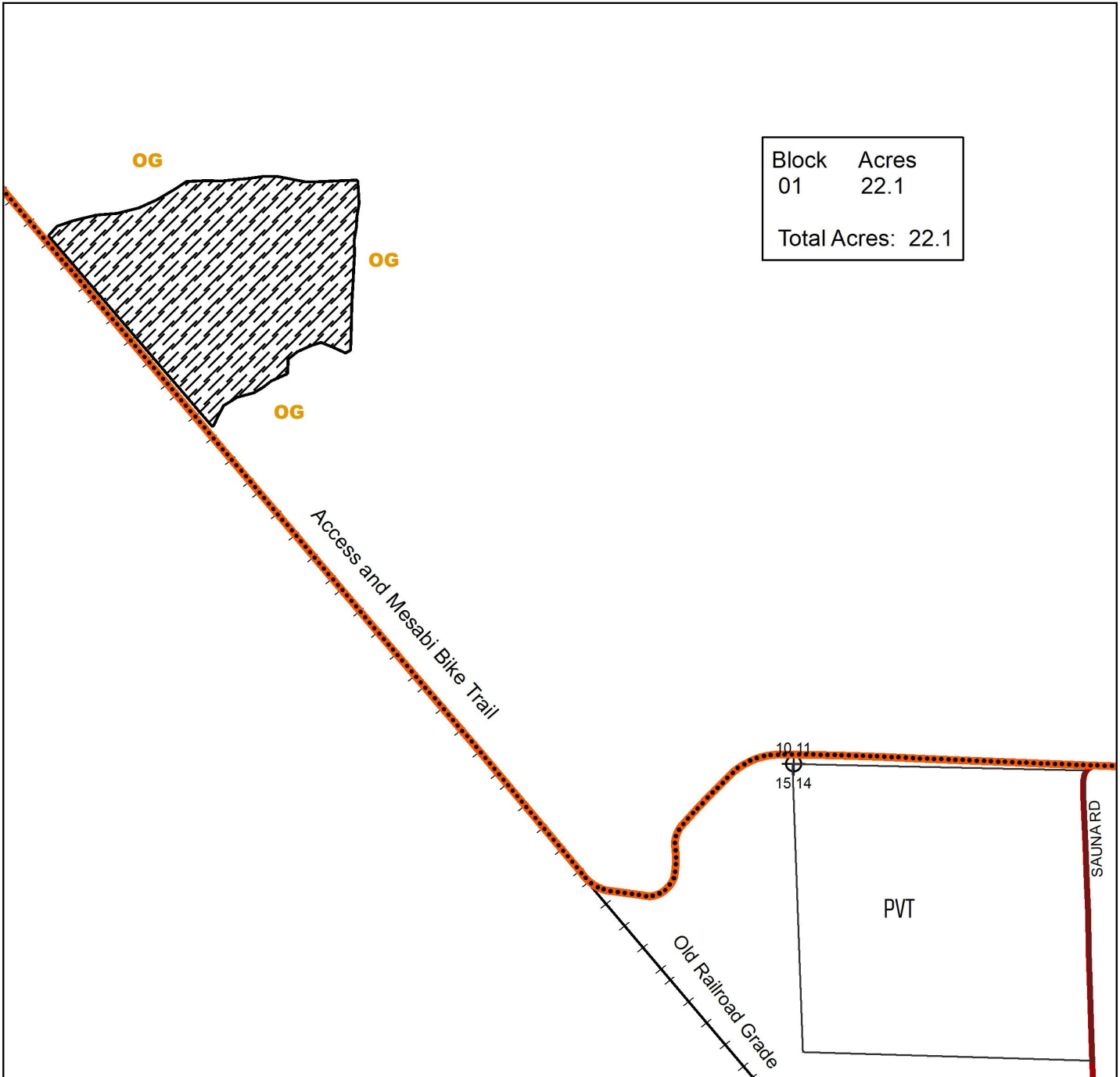

Prepared By: **Tom Salzer**

Map Created: 4/12/2024

TRS: 601510

Disclaimer:  
This is a compilation of records as they appear in the Saint Louis County Offices affecting the area shown. This drawing is to be used only for reference purposes and the County is not responsible for any inaccuracies herein contained.

0 0.075 0.15 Miles

 Decorative Forest Products  
Flagged in orange

PVT Private

OG Flagged Orange Line

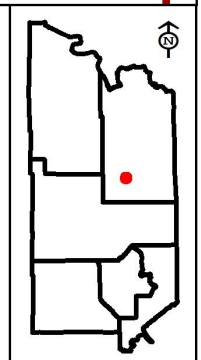



# St. Louis County August 01, 2024 Timber Auction

**Tract #: 3****V24-562033****Sale Administrator: Brandon Pierzina****Virginia Area****Total Appraised: \$28,905.80****Twp. 56N Rge. 20W Sec. 28, 33****C19240067****Down Payment Required: \$7,226.45****Total Acres: 104.4****Expires: 12/31/2025****47° 17.664' N 92° 53.262' W****Blocks: 4****Comments:**

- No extensions will be allowed.
- The 25% down payment of the appraised value is required with the purchase of the sale and will be held until satisfactory completion of the contract.
- Sale requirements involve a self-directed thinning of black spruce (see harvest provisions for details).
- Black Spruce merchantability is an individual piece where the live crown of the tree measures between 18" and 4' tall and less than 3" in diameter. Utilizing Black spruce merchantable pieces may require double cutting (see harvest provision 11.0.11).

**Access:**

Access to this black spruce top sale will be from the South Town Line Road (Co Rd 442) though Blandin Paper Company property. Access may require certain mechanized equipment, contact sale administrator for details.

Block	Operational Periods
1, 2, 3, 4	All Season

SOAV	Product	No Bid	Total Volume	Appraised Value	Total Value
<b>Total For All Blocks</b>					
	<b>Black Spruce soav-tops</b>		<b>144529 Pieces @</b>	<b>\$0.20 =</b>	<b>\$28,905.80</b>
<b>Total Appraised Value:</b>					<b>\$28,905.80</b>

Volume Per Block	Block 1	Block 2	Block 3	Block 4
Black Spruce soav-tops	45252	31134	42199	25944



C19240067

St. Louis County

V24-562033

Block	Acres
01	21.6
02	28.1
03a	2.6
03b	23.9
04	28.2

Total Acres: 104.4

Reserve all:  
-Black Spruce crop  
trees at 8ft x 8ft spacing.

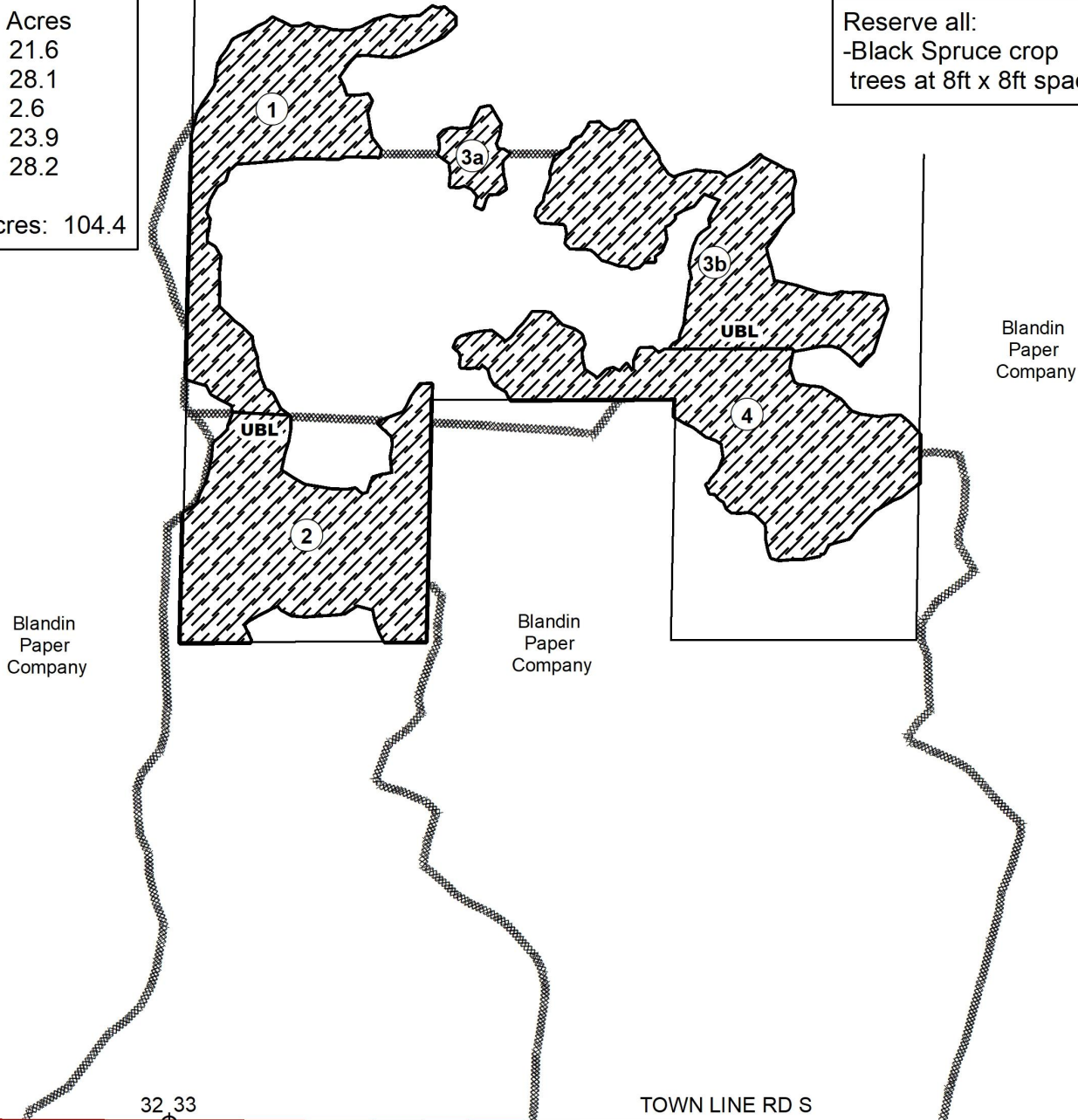

Blandin Paper Company

Blandin Paper Company

Blandin Paper Company

TOWN LINE RD S

32 33  
5 4



Prepared By: Brandon Pierzina

Map Created: 3/25/2024

TRS: 562033

Disclaimer:

This is a compilation of records as they appear in the Saint Louis County Offices affecting the area shown. This drawing is to be used only for reference purposes and the County is not responsible for any inaccuracies herein contained.

-  Decorative Forest Products Area (Black Spruce Top Removal) Boundary Marked With Orange Ribbon
-  Designated Access (Existing)
-  Section Corner
- UBL** Unpainted Block Line

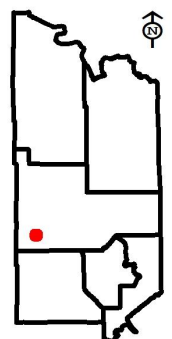
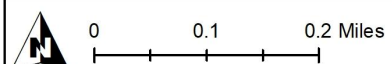



# St. Louis County August 01, 2024 Timber Auction

**Tract #: 4****B24-541215****Sale Administrator: Anna Earley****Pike Lake Area  
C19240068****Total Appraised: \$1,492.80****Twp. 54N Rge. 12W Sec. 15****Total Acres: 4****Down Payment Required: \$373.20****47° 10.087' N 91° 50.955' W****Blocks: 1****Expires: 4/15/2026****Comments:**

- This sale is being reoffered
- The 25% downpayment will be retained and will be held until the satisfactory completion of the contract.
- No extensions will be allowed.
- All Paper Birch stems under 4 inches diameter at the stump may be harvested. No residual stems are required for stump sprout clumps. Pieces are defined as an 8-foot section of a birch tree stems. A tree main contain more than 1 piece.

SOAV	Product	No Bid	Total Volume	Appraised Value	Total Value
<b>Total For All Blocks</b>					
	Birch soav-stems		6220 Pieces @	\$0.24 =	\$1,492.80
<b>Total Appraised Value:</b>					<b>\$1,492.80</b>

C19240068

St. Louis County  
B24-541215

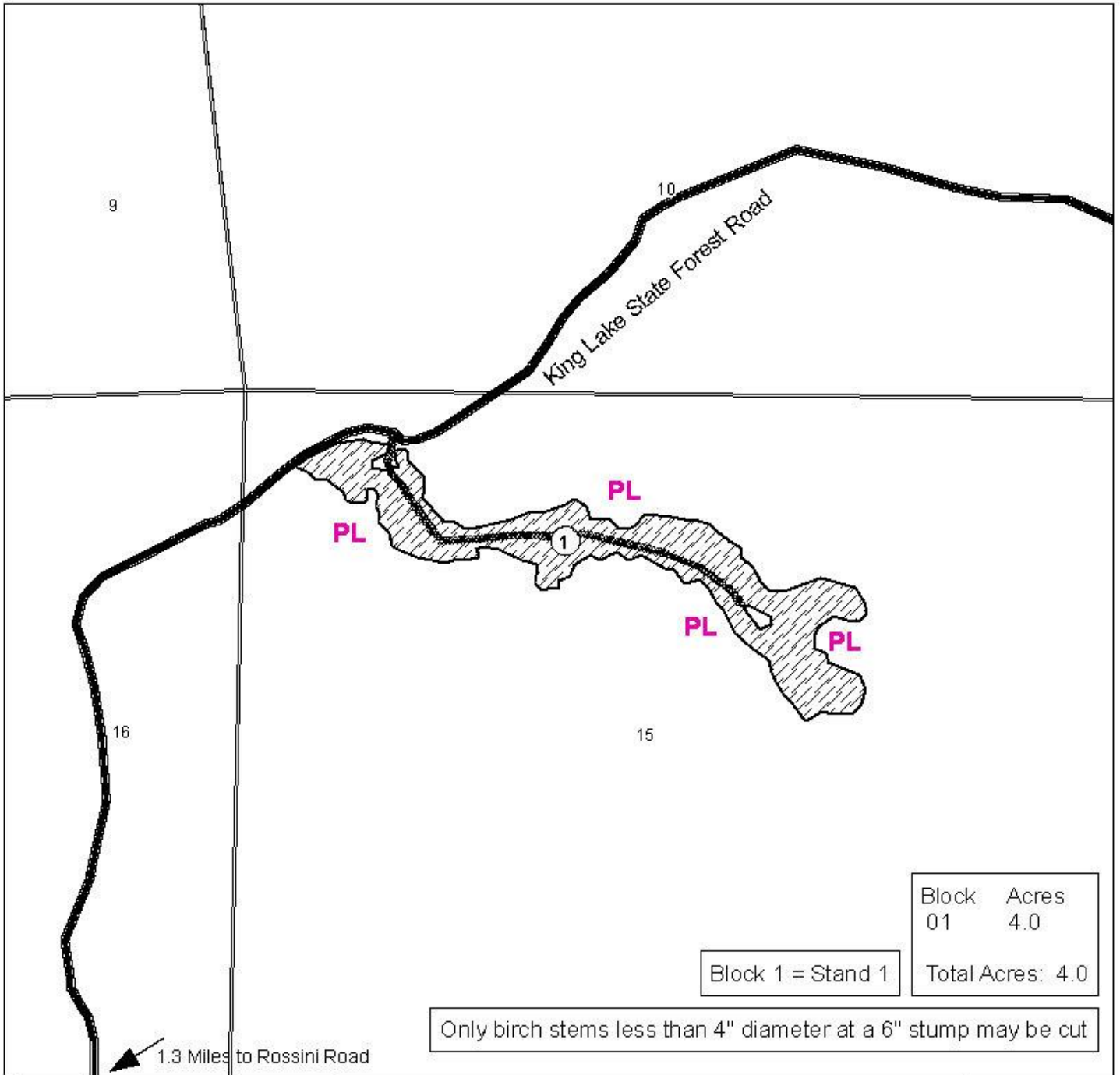

Prepared By: Anna Earley  
Map Created: 3/17/2023  
TRS: 541215  
Disclaimer:  
This is a compilation of records as they appear in the Saint Louis County Offices affecting the area shown. This drawing is to be used only for reference purposes and the County is not responsible for any inaccuracies herein contained.

-  Decorative Products Removal Birch Stem Harvest Area
-  Pink Painted Harvest Line
-  State Forest Road
-  Existing ATV Trail

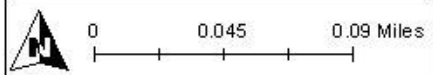
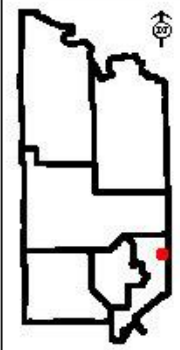



# St. Louis County August 01, 2024 Timber Auction

**Tract #: 5****B24-541411****Sale Administrator: Robert Benson****Pike Lake Area****Total Appraised: \$690.00****Twp. 54N Rge. 14W Sec. 10, 11, 12, 15****C19240070****Down Payment Required: \$172.50****Total Acres: 36.3****Expires: 4/15/2026****47° 10.661' N 92° 4.877' W****Blocks: 1****Comments:**

- This sale is being reoffered
  - The 25% downpayment will be retained and will be held until the satisfactory completion of the contract.
  - No extensions will be allowed.
  - Pieces are defined as an 8 foot section of birch tree stems under 4 inches at 6" above ground level. A tree may contain more than 1 piece.
- The sale is a roadside birch stem removal site with a sale boundary located 66' from the centerline of the road.

SOAV	Product	No Bid	Total Volume	Appraised Value	Total Value
<b>Total For All Blocks</b>					
	Birch soav-stems		2760 Pieces @	\$0.25 =	\$690.00
<b>Total Appraised Value:</b>					<b>\$690.00</b>

C19240070

St. Louis County  
B24-541411

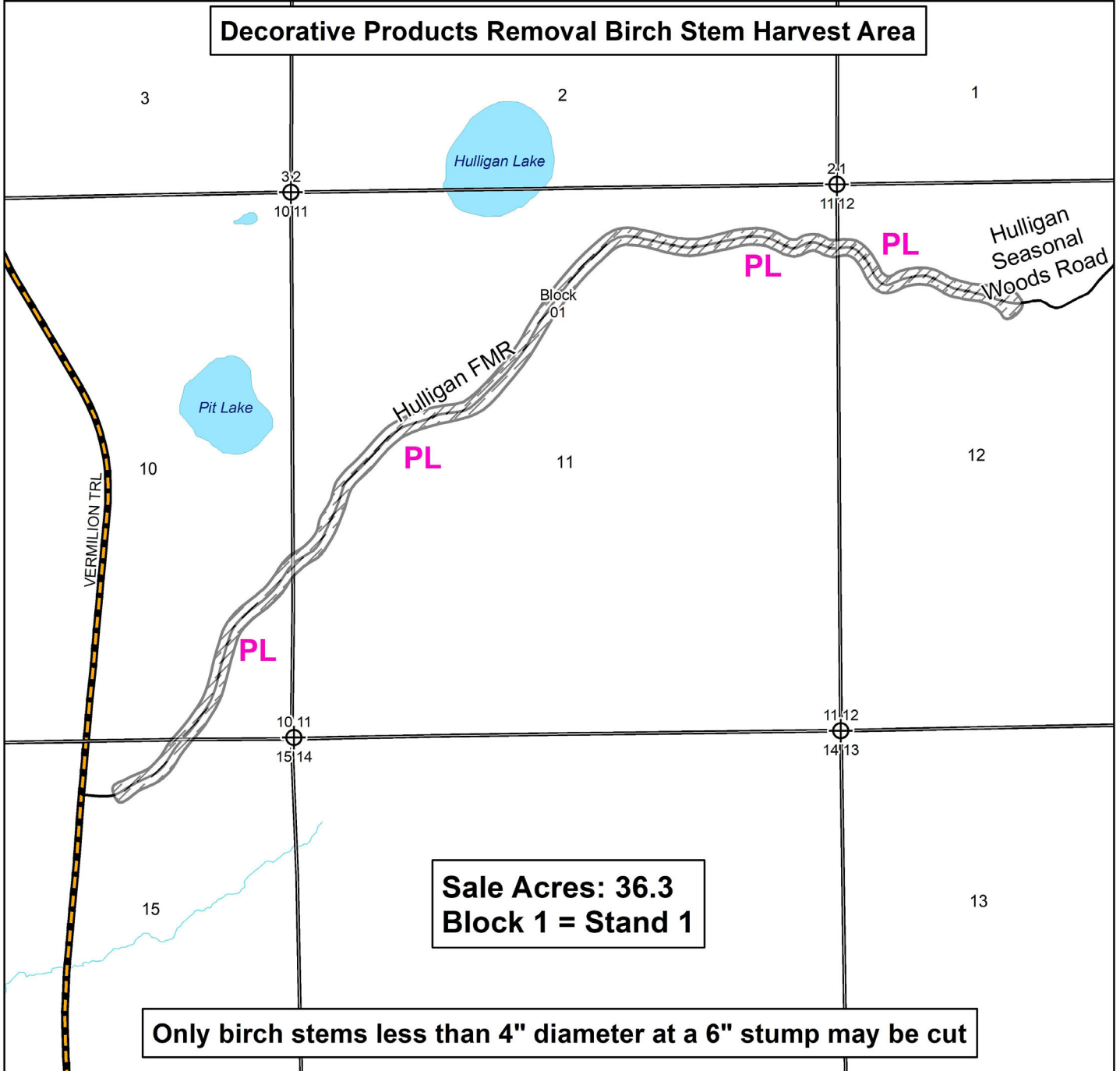

Prepared By: R. Benson  
Map Created: 5/21/2024  
TRS: 541411

**Disclaimer:**  
This is a compilation of records as they appear in the Saint Louis County Offices affecting the area shown. This drawing is to be used only for reference purposes and the County is not responsible for any inaccuracies herein contained.

0 0.175 0.35 Miles

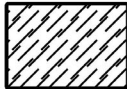
 Birch Stem Harvest Area

**PL** Pink Painted Harvest Line

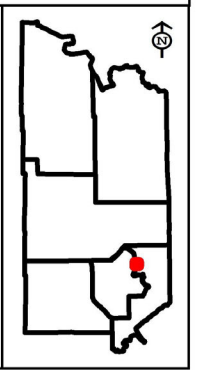





## St. Louis County August 01, 2024 Timber Auction

Tract #: 6

F24-531808

Sale Administrator: Alexander Richardson

Pike Lake Area  
C19240071

Total Appraised: \$843.60

Twp. 53N Rge. 18W Sec. 8

Down Payment Required: \$210.90

Total Acres: 5.7

Expires: 12/31/2025

47° 5.231' N 92° 38.532' W

Blocks: 1

### Comments:

- No extensions will be allowed.
- The 25% down payment of the appraised value is required with the purchase of the sale and will be held until satisfactory completion of the contract.
- Sale requirements involve cutting tamarack with a self-directed thinning of black spruce (see harvest provisions for details).
- Black Spruce merchantability is an individual piece where the live crown of the tree measures between 18" and 4' tall and less than 3" in diameter. Black spruce pieces are not to be harvested past 12' up the bole of the tree.
- Competition to be removed is tamarack averaging 1" DBH, 1,450 trees per acre.
- Spruce top harvest averages 1,480 trees/acre

SOAV	Product	No Bid	Total Volume	Appraised Value	Total Value
<b>Total For All Blocks</b>					
	Black Spruce soav-tops		8436 Pieces @	\$0.10 =	\$843.60
<b>Total Appraised Value:</b>					<b>\$843.60</b>

C19240071

St. Louis County

F24-531808

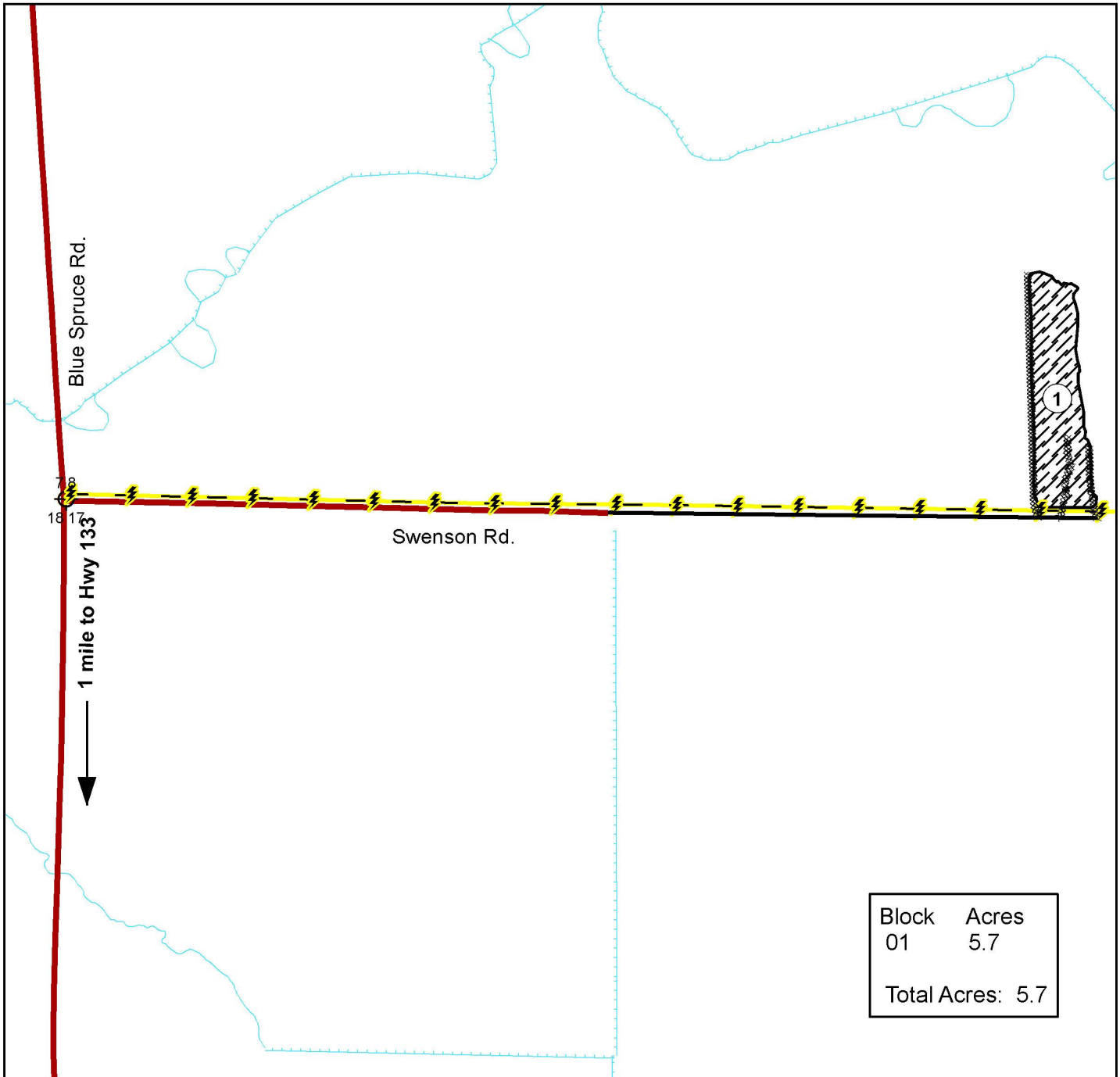

Prepared By: Alex Richardson

Map Created: 3/26/2024

TRS: 531808

Disclaimer:  
This is a compilation of records as they appear in the Saint Louis County Offices affecting the area shown. This drawing is to be used only for reference purposes and the County is not responsible for any inaccuracies herein contained.

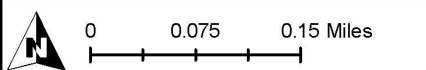

-  Spruce Tops
-  Decorative Forest Products
-  Existing Skid Trail
-  Seasonal Woods Road
-  Public Road
-  Overhead Powerline

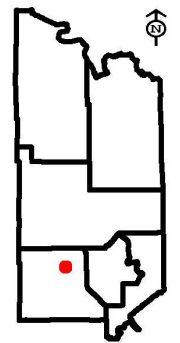



# St. Louis County August 01, 2024 Timber Auction

Tract #: 7

F24-541934

Sale Administrator: Alexander Richardson

Pike Lake Area

Total Appraised: \$13,848.30

Twp. 54N Rge. 19W Sec. 34

C19240072

Down Payment Required: \$3,462.08

Total Acres: 54.2

Expires: 12/31/2025

47° 6.718' N 92° 44.141' W

Blocks: 4

### Comments:

- No extensions will be allowed.
- The 25% down payment of the appraised value is required with the purchase of the sale and will be held until satisfactory completion of the contract.
- Black Spruce merchantability is an individual piece where the live crown of the tree measures between 18" and 4' tall and less than 3" in diameter. Black spruce pieces are not to be harvested past 12' up the bole of the tree.
- Competition to be removed is tamarack averaging .5" DBH, 3,411 trees per acre.
- Spruce top harvest averages 2,555 trees/acre

SOAV	Product	No Bid	Total Volume	Appraised Value	Total Value
<b>Total For All Blocks</b>					
	Black Spruce soav-tops		138483 Pieces @	\$0.10 =	\$13,848.30
<b>Total Appraised Value:</b>					<b>\$13,848.30</b>

Volume Per Block	Block 1	Block 2	Block 3	Block 4
Black Spruce soav-tops	32444	28221	28011	49807

C19240072

St. Louis County

F24-541934

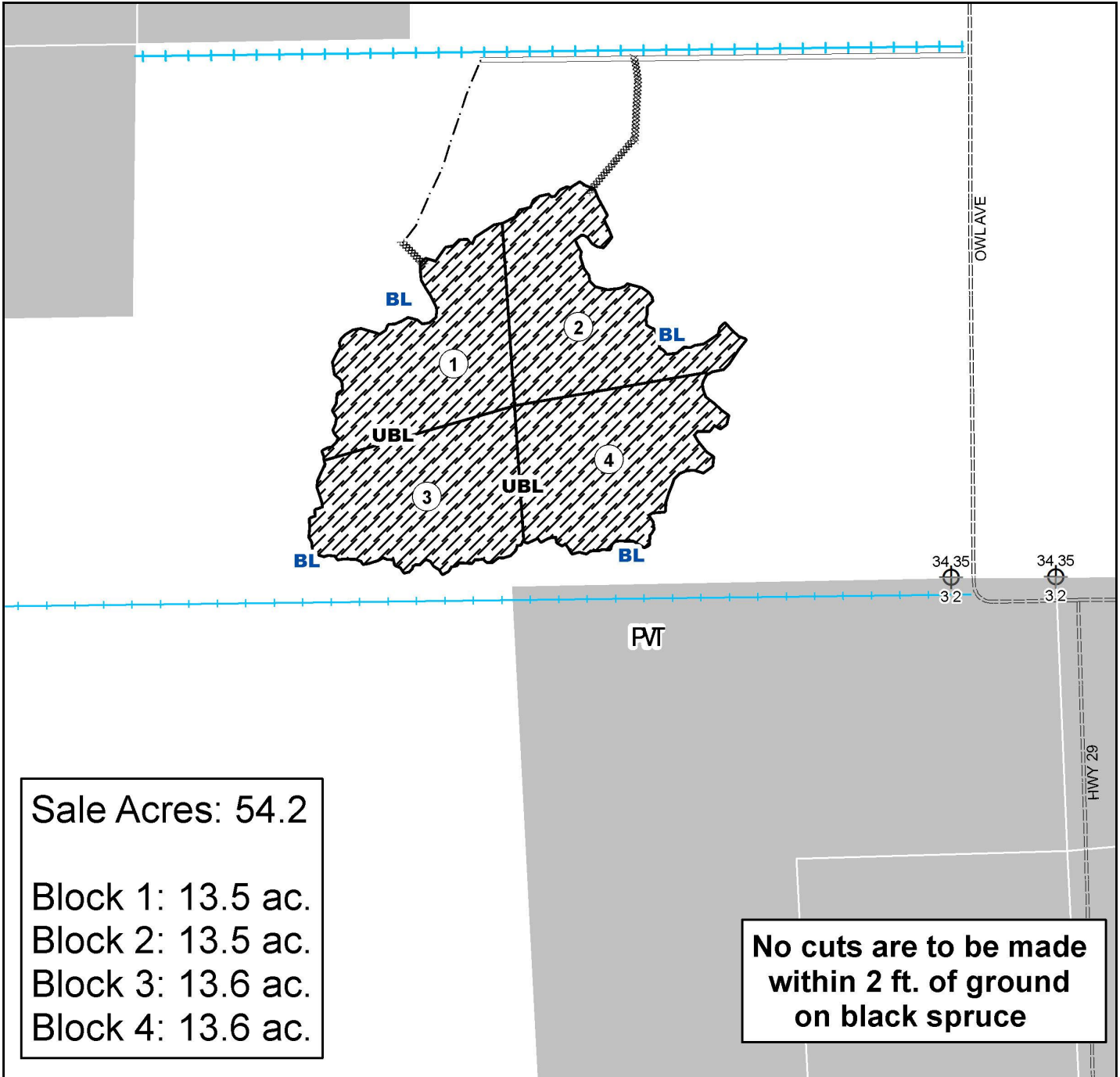

Sale Acres: 54.2

Block 1: 13.5 ac.  
Block 2: 13.5 ac.  
Block 3: 13.6 ac.  
Block 4: 13.6 ac.

No cuts are to be made within 2 ft. of ground on black spruce

Prepared By: Alex Richardson  
Map Created: 05/01/2024  
TRS: 54-19-34

Disclaimer:  
This is a compilation of records as they appear in the Saint Louis County Offices affecting the area shown. This drawing is to be used only for reference purposes and the County is not responsible for any inaccuracies herein contained.

0 0.075 0.15 Miles

- Spruce Tops Decorative Forest Products
- Proposed Access Road
- Ditchbank Road
- Gravel Road
- Winter Road Spur

- BL** Painted Blue Line
- Ditch
- PVT** Private

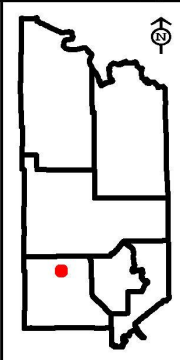



# St. Louis County August 01, 2024 Timber Auction

Tract #: 8

K24-531318

Sale Administrator: Erik Anton

Pike Lake Area

Total Appraised: \$10,128.30

Twp. 53N Rge. 13W Sec. 18 and Twp. 53N Rge. 14W

C19240073

Down Payment Required: \$2,532.08

Sec. 13

Total Acres: 31.9

Expires: 12/31/2025

47° 4.278' N 92° 2.817' W

Blocks: 1

### Comments:

- The 25% down payment of the appraised value is required with the purchase of the sale and will be held until satisfactory completion of the contract.
- No extensions will be allowed.
- Black spruce pieces are not to be harvested past 12' up the bole of the tree

### Access:

Sale will be accessed off the North Alden Lake Forest Management Road. A pre-existing timber sale access can be used to get within 250 feet of the sale area, this trail can be brushed back for vehicle access.

Block	Operational Periods
1	All Season

SOAV	Product	No Bid	Total Volume	Appraised Value	Total Value
<b>Total For All Blocks</b>					
	Black Spruce soav-tops		33761 Pieces @	\$0.30 =	\$10,128.30
<b>Total Appraised Value:</b>					<b>\$10,128.30</b>



C19240073

St. Louis County

K24-531318

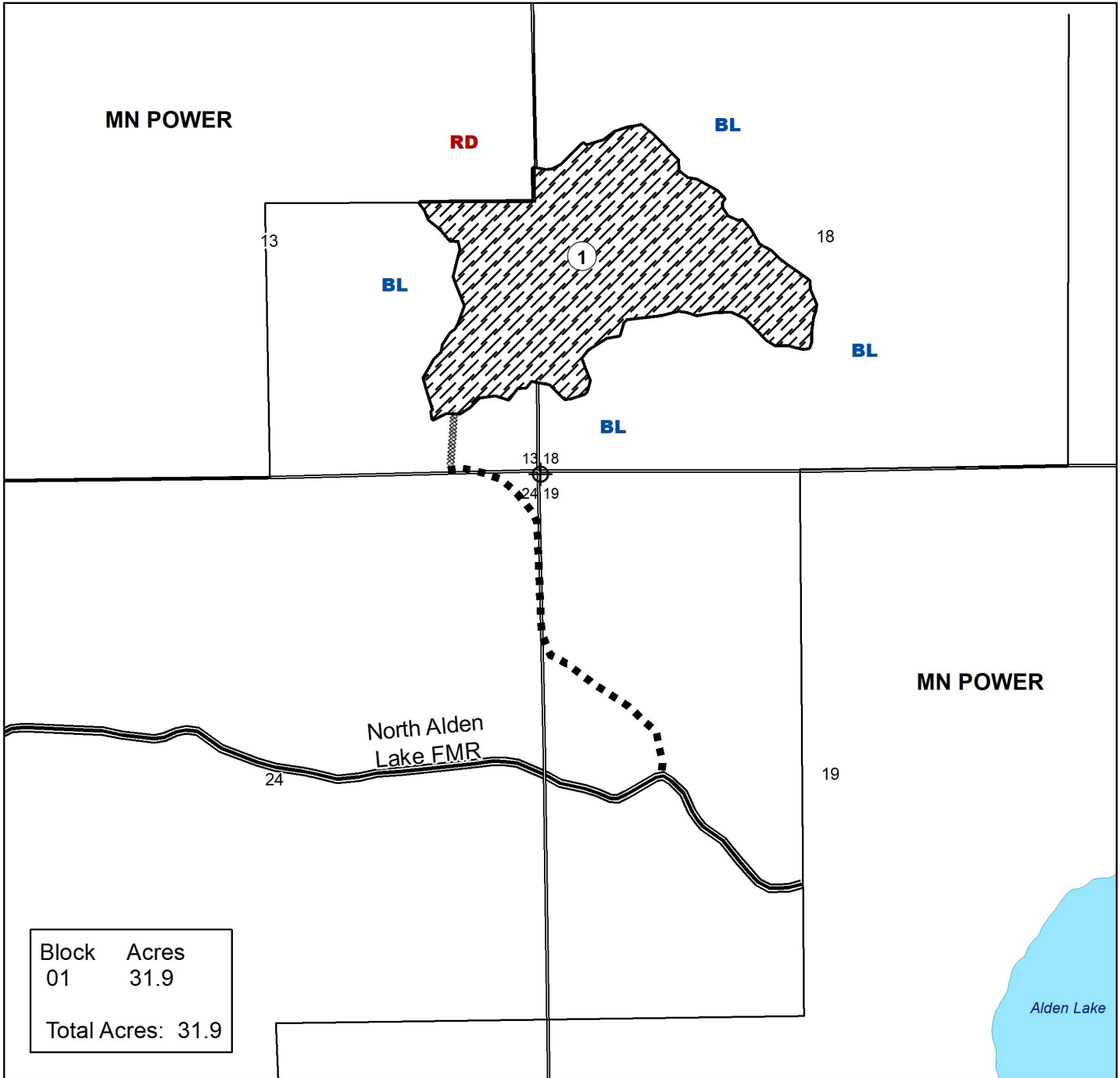

Prepared By: Erik Anton

Map Created: 1/4/2024

TRS: 531318

Disclaimer:

This is a compilation of records as they appear in the Saint Louis County Offices affecting the area shown. This drawing is to be used only for reference purposes and the County is not responsible for any inaccuracies herein contained.

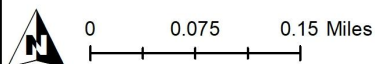

Decorative Forest Products



ATV Access Trail (possible vehicle access)



Proposed Access

BL

Painted Blue Line

RD

Painted Red Line

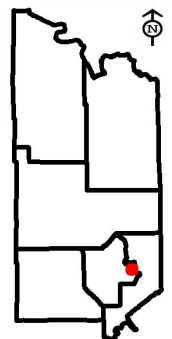

This Page Intentionally Left Blank





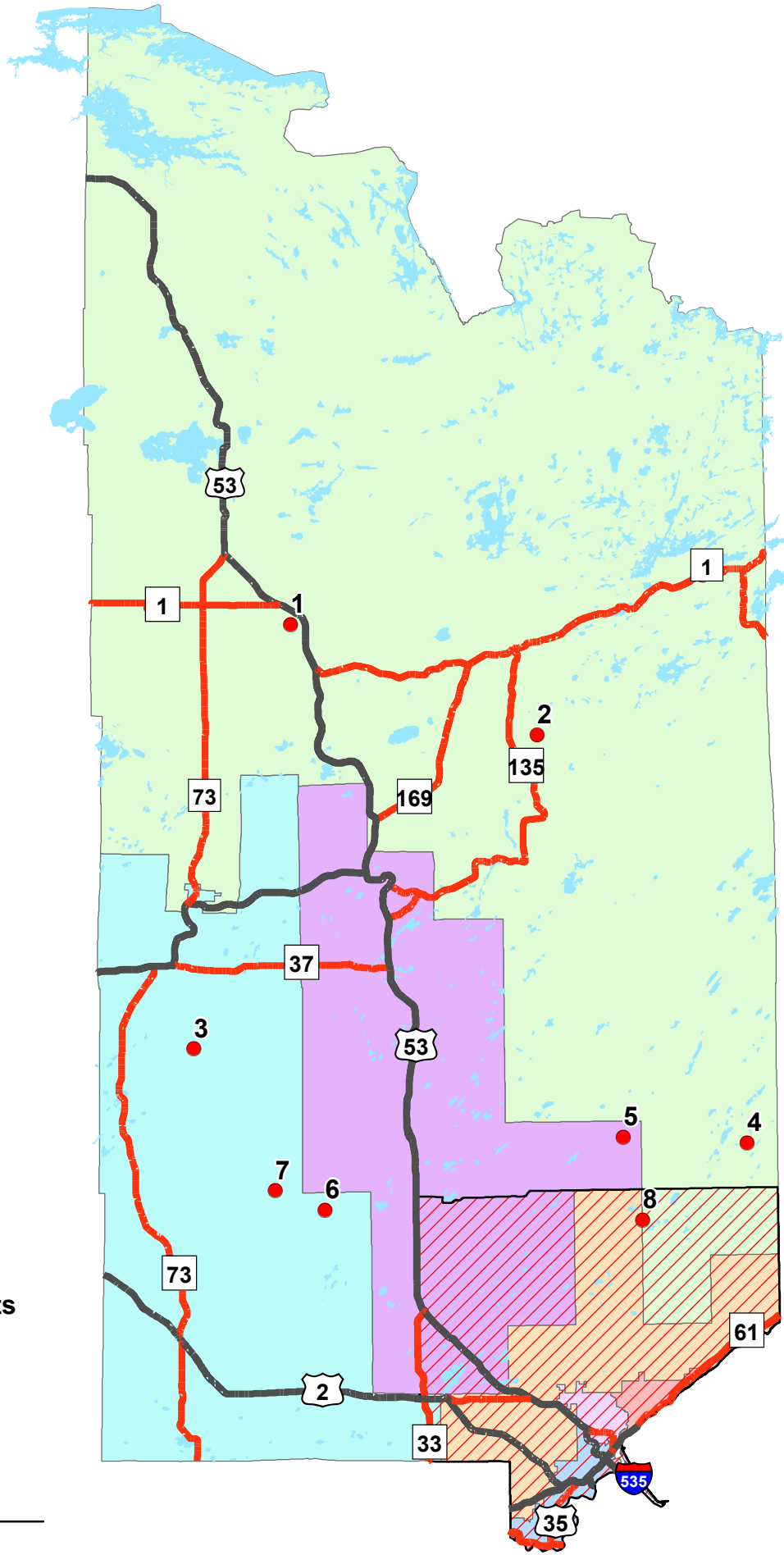

This Page Intentionally Left Blank



This Page Intentionally Left Blank

# Tract Locations



## Commissioner Districts

- |   |   |
|---|---|
|  1 |  4 |
|  2 |  5 |
|  3 |  6 |
|  7 |   |

-  Tracts
-  Emerald Ash Borer Quarantine







S A I N T  
**LOUIS** ❖  
**COUNTY**  
M I N N E S O T A

# Land and Minerals Department

## Decorative Products Sealed Bid Auction

Bid opening: August 1, 2024 at 9:30 a.m.

Duluth Government Services Center

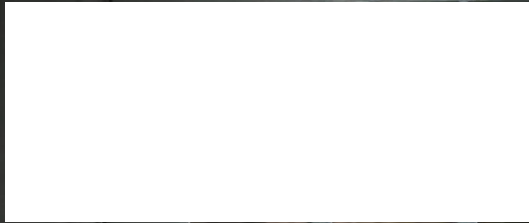

**Barrier Free:** All St. Louis County Timber Auctions are accessible to people with disabilities. Attempts will be made to accommodate any other individual needs for special services. Contact the St. Louis County Land and Minerals Department (218-726-2606) prior to the auction, so necessary arrangements can be made.

[stlouiscountymn.gov](http://stlouiscountymn.gov)